

## Rough Opening Preparation & Product Dimensions

**Note:** Allow 1/2" additional room on all sides of the rough opening (1" overall) than recommended by window manufacturers' instructions to accommodate the 1/2" tongue of ThermalBuck.

- Consider continuous insulation and/or rainscreen depth.



ThermalBuck features an integrated sill pan with a slope of 1/16" on all 8' lengths.

Download detailed installation instructions with photos at [thermalbuildingsupply.com](http://thermalbuildingsupply.com)

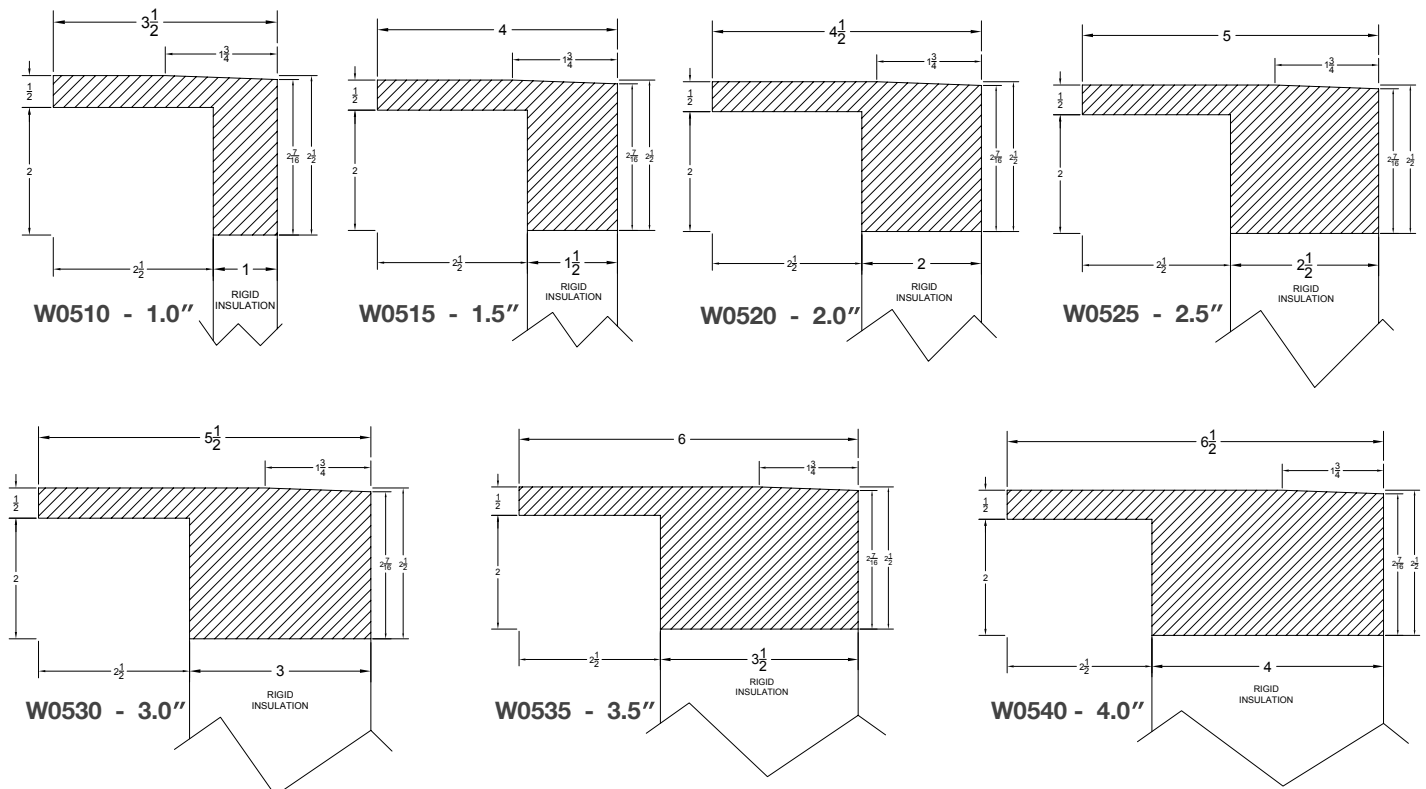
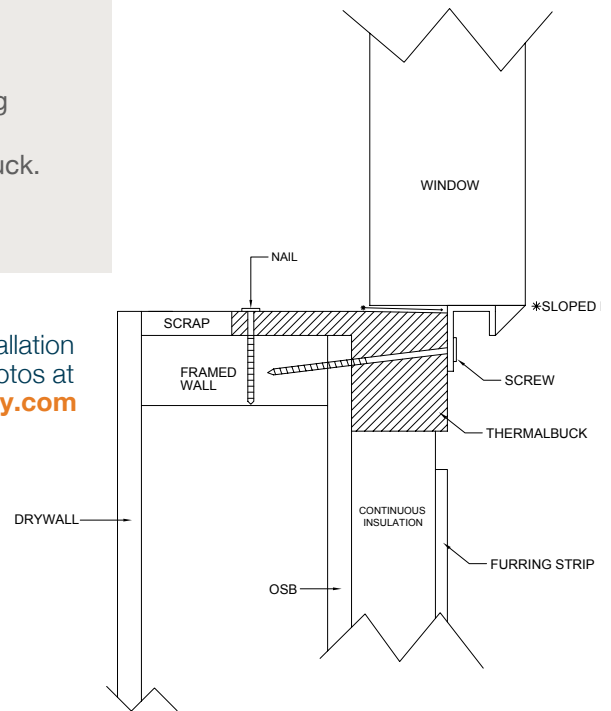

## Note:

For additional information please refer to following document, FMA/AAMA/WDMA 500-16 Standard Practice for the Installation of Mounting Flange Windows into Walls Utilizing Foam Plastic Insulation (FPIS) with a Separate Water-Resistive Barrier (WRB).

## Materials Needed for Installation

- DAP Dynaflex 800\* or recommended sealant & Sealant Gun
- 2" Galvanized Roofing Nails for ThermalBuck
- #10 Nails or Screws for flange (penetrate 1-1/4" into structure)
- Flashing Tape to cover window nail flange & J-Roller
- Miter Saw

\*DAP 3.0 in Canada